



12 Smith Street FAIRY MEADOW, NSW

 4
  2
  2

Location, Convenience, Lifestyle!

Ideally located and with a very practical floor plan, this light-filled three to four bedroom home offers classic features and is conveniently located only moments to local attractions including pristine beaches, boutique stores, bakery, major grocery outlets, transport, schools, restaurants and cafes.

On a generous level block in a cul-de-sac position, the property has a land size of 753m² with a frontage of just over 15m creating endless possibilities for improvements or development (STCA).

- Land size of approx. 753m²
- Three spacious bedrooms
- Retro kitchen with ample storage space
- Fourth bedroom or studio

Danny Mojanovski Melissa Lott

0424163173

0424939178

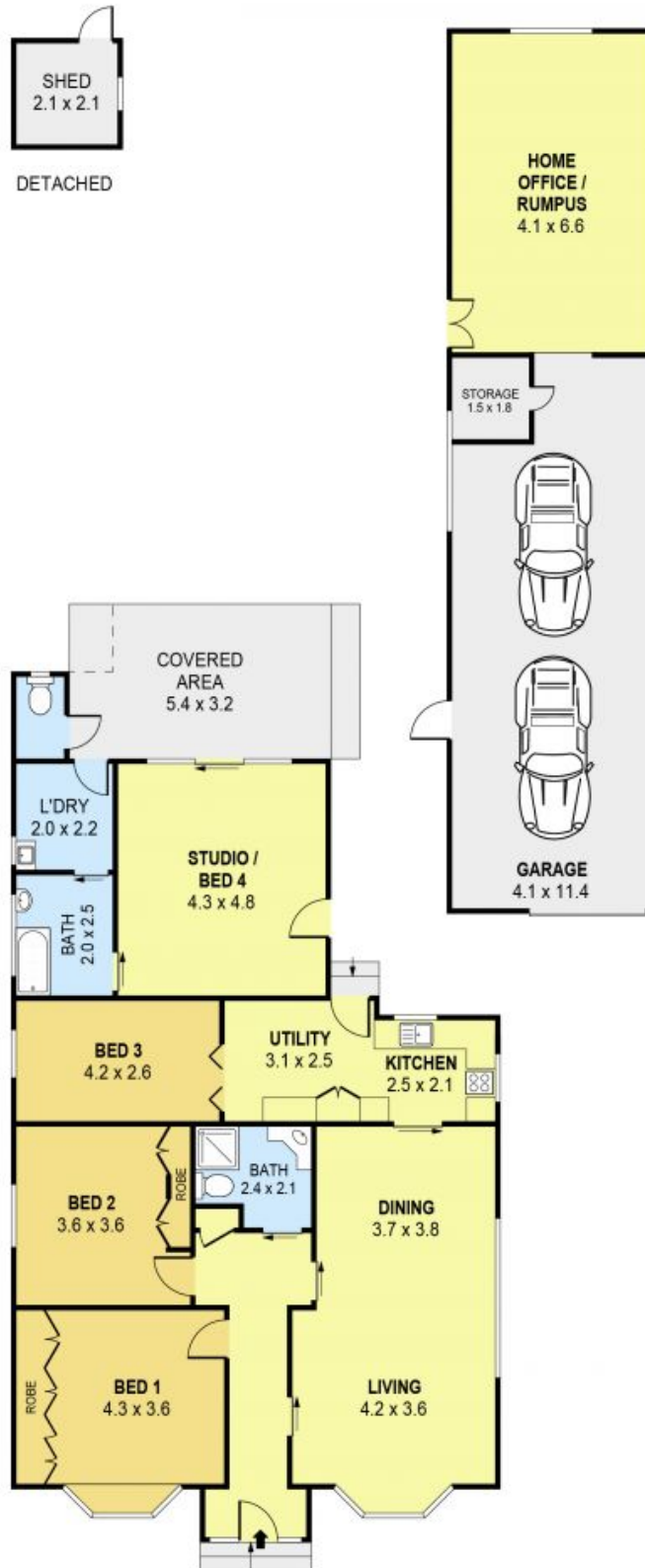

INT	: 136m ²
EXT	: 19m ²
GARAGE	: 47m ²
HOME OFFICE	: 27m ²
SHED	: 4m ²



SCALE (METRES)

PLANS SHOWN ONLY INDICATIVE OF LAYOUT. DIMENSIONS ARE APPROXIMATE.
Ref. No. 95211

12 SMITH STREET
12 Smith Street

FAIRY MEADOW, NSW

