



3/15 Daisy Street FAIRY MEADOW, NSW



Perfectly Positioned for Convenient Living

In a prominent central location and close to all amenities, this residence combines a spacious 184sqm family friendly floor plan with an exclusive and convenient lifestyle. Ideally set within the boutique shopping precinct of Fairy Meadow, you will enjoy the lifestyle this property offers with pristine beaches within walking distance and the vibrant city of Wollongong only a short drive away.

- Tri level home showcasing quality finishes
- Located near main arterial highways to Sydney and South Coast
- Practical layout perfectly caters to young families or investors
- Living and dining areas interact seamlessly with the outdoors
- Flows to terraces with escarpment views
- Caesar Stone gas kitchen plus quality stainless steel appliances

Danny
0424 163 173
(LREA)

Mojanah & Missa Lott (LREA)
0424 939 178



UPPER LEVEL

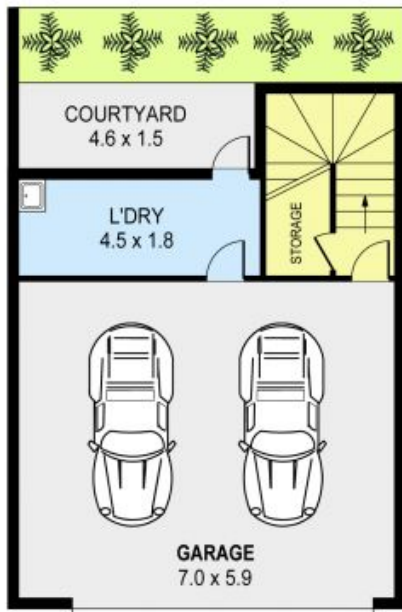

LOWER LEVEL

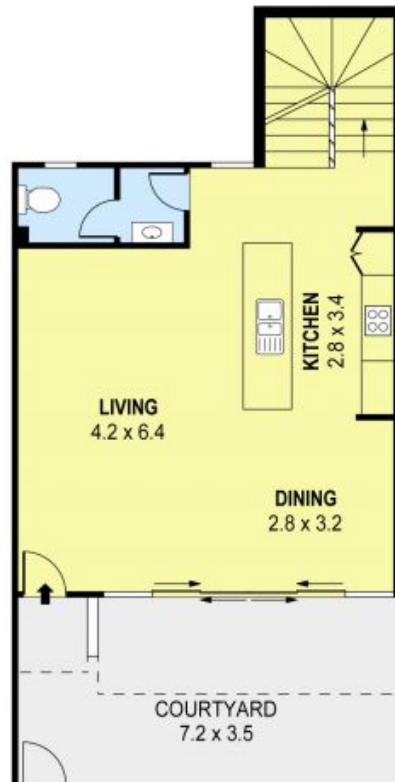

GROUND LEVEL



PLANS SHOWN ONLY INDICATIVE OF LAYOUT. DIMENSIONS ARE APPROXIMATE.
Ref. No. 56778

INT : 143m²
EXT : 32m²
GARAGE : 41m²

UNIT 3, 15 DAISY STREET
3/15 Daisy Street

FAIRY MEADOW, NSW

