



69-71 Five Islands Rd CRINGILA, NSW

UNDER CONTRACT

A fantastic opportunity for the astute investor to secure a high exposure, modern industrial warehouse with long term national tenant. Located in close proximity to Blue Scope Steel, Port Kembla Harbour and M1 Freeway.

10 year Lease with 5 + 5 year Option (Commenced 5th Nov 2012)

Nett Rental Return \$109,145 p.a

Zoned IN2 Light Industrial

Floor area of approx 600 sqm

Mezzanine approx 36 sqm

Large Purpose Built 225 sqm Cool Room with 2 Loading Bays

10 On Site Parking Spaces

High Roller Door Access

Air-Conditioned Office space

Danny

Mojanovski

0424 163 173
(LREA)

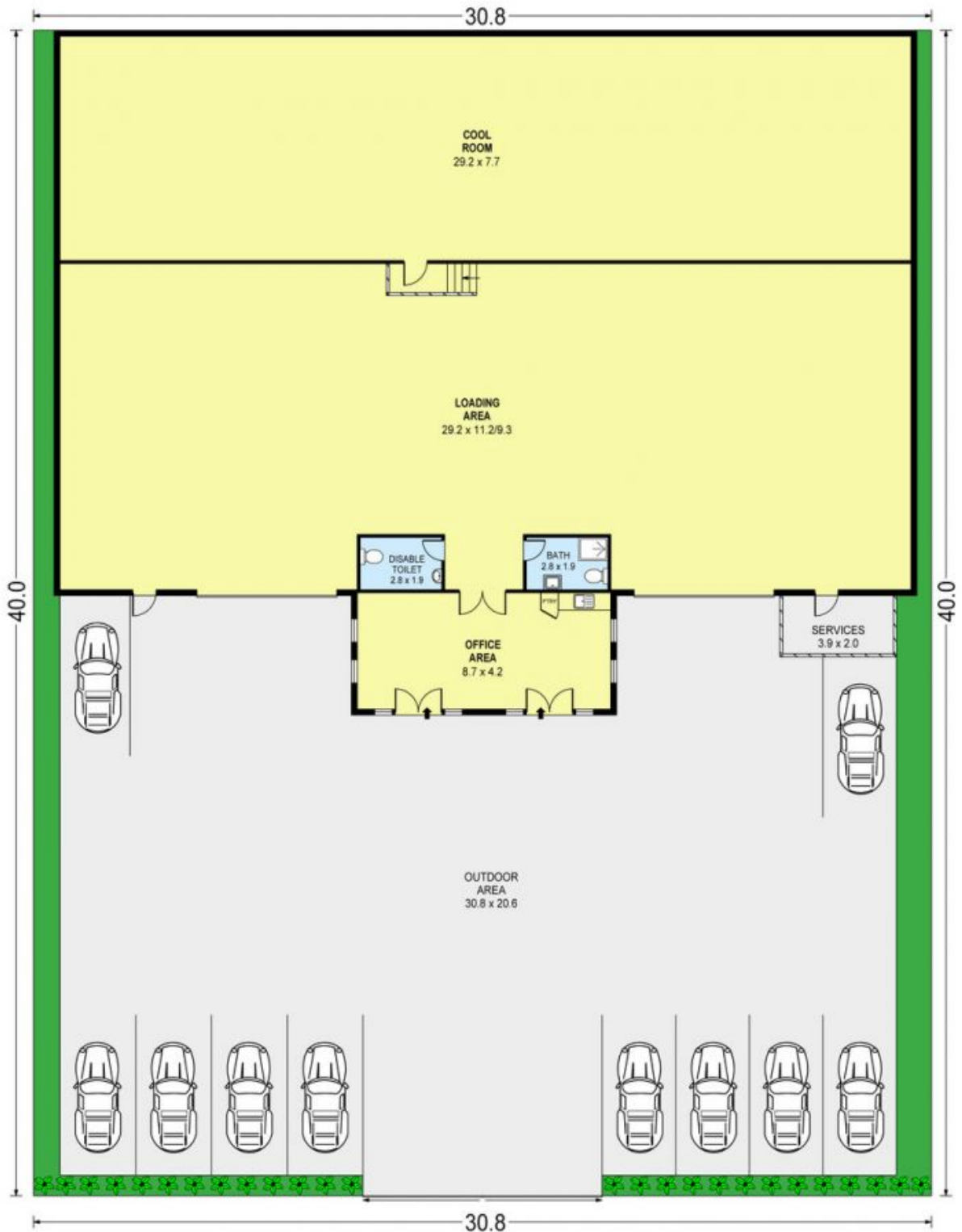

SCALE (METRES)

PLANS SHOWN ONLY INDICATIVE OF LAYOUT. DIMENSIONS ARE APPROXIMATE.
Ref. No. 32932

INT : 590m²
SITE AREA : 620m²

65-67 FIVE ISLANDS ROAD

CRINGILA, NSW

