



11/124 Princes Hwy FAIRY MEADOW, NSW



1



1



1

Modern Apartment with Views

Stylish and contemporary, this apartment features combined living and dining areas that flow out to a terrace with ocean and escarpment views. A chic, modern kitchen with stone bench tops and stainless steel appliances, a double size bedroom with built in wardrobe and a sleek modern bathroom. Also features an Internal laundry and a secure car space.

Perfectly positioned only metres from Fairy Meadow restaurant, cafe and retail precinct and opposite Wollongong's free shuttle service. An excellent lifestyle or investment opportunity minutes from the beach, UOW Innovation Campus and Wollongong CBD.

Council Rates: \$1,110.00/year (approx)

Water Rates: \$720.00/year (approx)

Strata Rates: \$2,668.00/year (approx)

Diana Mojanovski

Danny

Mojanovski

0424 163 173
(LREA)

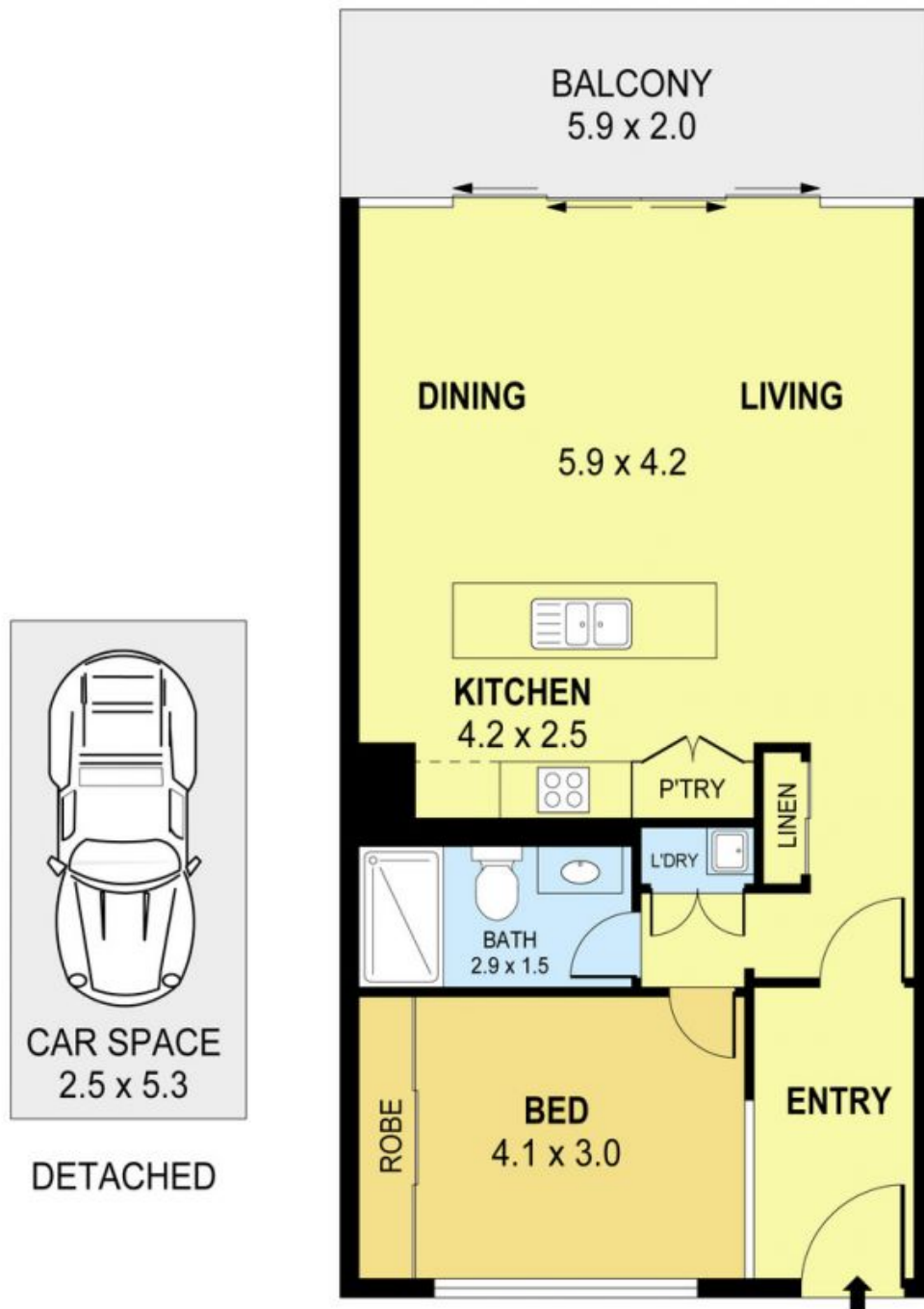

PLANS SHOWN ONLY INDICATIVE OF LAYOUT. DIMENSIONS ARE APPROXIMATE.
Ref. No: 30568

INT : 67m²
EXT : 12m²
CAR SPACE : 13m²

UNIT 11, 118-126 PRINCES HIGHWAY, FAIRY MEADOW, NSW

Property Management
Fairy Meadow